

CITY OF MURRAY CONTROL MONUMENT CARD

DESIGNATION: E8 GPS
TYPE: CONCRETE MONUMENT W/ CITY DISK
DATE SET: JUNE 1997 QUAD: MURRAY, KY.
HORIZONTAL DATUM: NAD-83 VERTICAL DATUM: NAVD-88
STATE: KENTUCKY COUNTY: CALLOWAY ZONE: KY. S 1602

NORTHING: 1741419.21 FT
EASTING: 895947.02 FT
ELEVATION: 512.97 FT (GPS)
LATITUDE: N 36°34'59.89119" LONGITUDE: W 088°17'08.62193"
SCALE: CONVERGENCE:
PLANE AZI. TO AZI. MARK:

To Reach: From the intersection of State Route 121 and Applewood Rd., go northwest along State Route 121 for 0.34 miles to the station on the right.

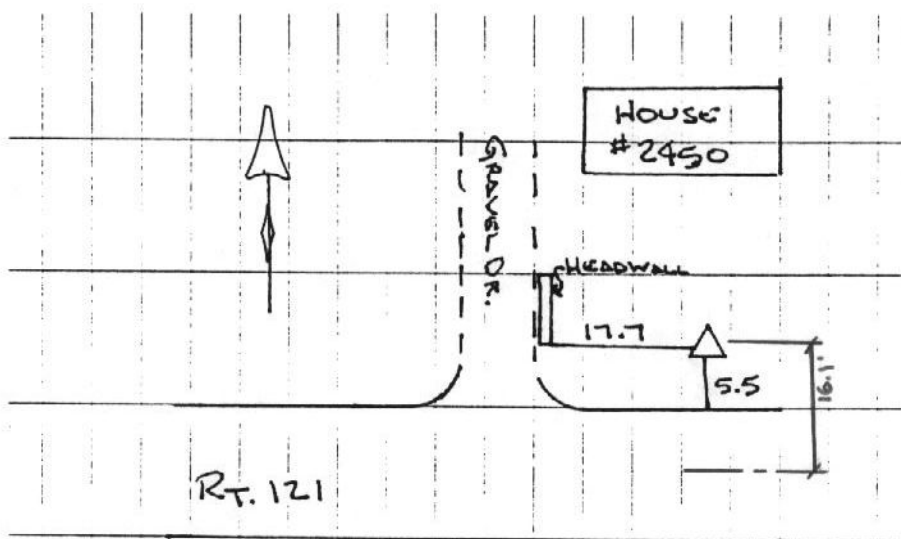

NOT TO SCALE



GRW Aerial Surveys, Inc.
801 Corporate Dr. Lexington Ky. 40503
(606)223-3999